



STEP 1 – PRIOR TO INSTALLATION

- A) Bushwacker only approves installing the Trail Armor according to these written instructions with the hardware provided. WARNING:** Failure to install according to these instructions will invalidate the warranty. This includes, but is not limited to using alternative installation methods, hardware, or materials. **DO NOT USE:** Loctite, SuperGlue, or similar products on the hardware or the flares.
- B) Fit:** Verify the fit of the Trail Armor to vehicle. (Some filing, sanding, or cutting may be necessary to ensure proper fit).
- C) Painting:** (Optional) if paint is desired it must be done prior to installing Trail Armor on vehicle. Clean outer surface with a good grade degreaser. **DO NOT USE LACQUER THINNER OR ENAMEL REDUCER AS A DEGREASER.** Wipe outer surface thoroughly with a tack rag prior to paint. Application of plastic adhesion promoter for ABS plastic as per your paint system manufacturer's recommendations is required. Paint Trail Armor using a high quality enamel, or polyurethane automotive paint. If painting edge trim (not recommended), use a flex additive.

Jeep® Trail Armor® Rocker Panel & Sill Plate Combo Pair

Pair Part #14012
Rev-6 9/29/2016

TOOLS FOR EASY INSTALLATION:

- #2 Phillips Screwdriver
- Cleaning Cloth
- Marker
- Masking Tape

LIMITED LIFETIME WARRANTY AGAINST ANY MANUFACTURING DEFECTS

- To claim a warranty, you must provide Proof of Purchase.

Included in Hardware Kit:

- | | | | | | |
|----|---|----|---|----|---|
| 1. |  | 2. |  | 3. |  |
| | AD1-0008,
ALCOHOL PREP
PAD,
2 pcs | | CL1-0022,
#10 "U" Clip,
12 pcs | | SW1-0056,
#8 x 3/4"
PH Screw,
12 pcs |

Side Panels Installation Procedures (Driver's Side):

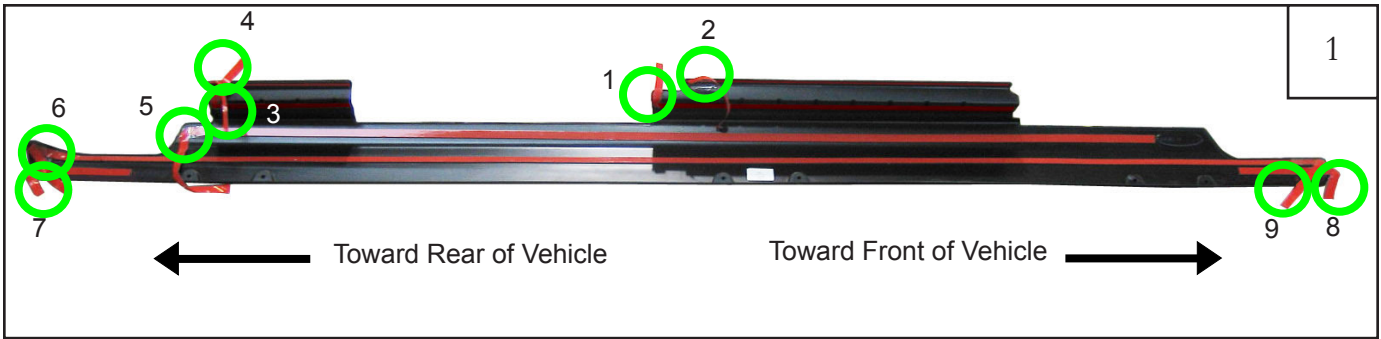

Using a marker, number the tape tabs for the tape liners as shown:

- 1: 1/2" Tape tab
- 2: 1/4" Tape tab
- 3: 1/2" Tape tab
- 4: 1/4" Tape tab
- 5: 1/2" Tape tab, This tab must hang down for removal from tape.
- 6: 1/2" Tape tab, The tabs at both ends of this tape must hang down for removal from tape.
- 7: 1/2" Tape tab
- 8: 1/2" Tape tab



OPTIONAL: Using masking tape, secure tabs to the outside of part for easy access.



Open door, clean all dirt and debris from vehicle door sills, rocker panel, and beneath flares (if installed). Then, use supplied alcohol wipe (AD1-0008) where part will be positioned. *NOTE: Temperature should be at least 60°F for proper tape adhesion.*

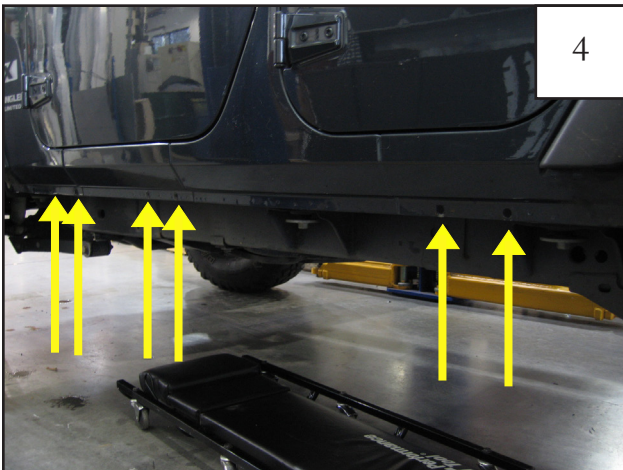

Locate the six factory holes in the rocker.



Place a clip over each hole with threaded portion of clip on the inside.



6
Place part on vehicle, making sure to line up edges of part with edges of vehicle and holes in part with clips installed in step 4. Ensure that all tape tabs are accessible.

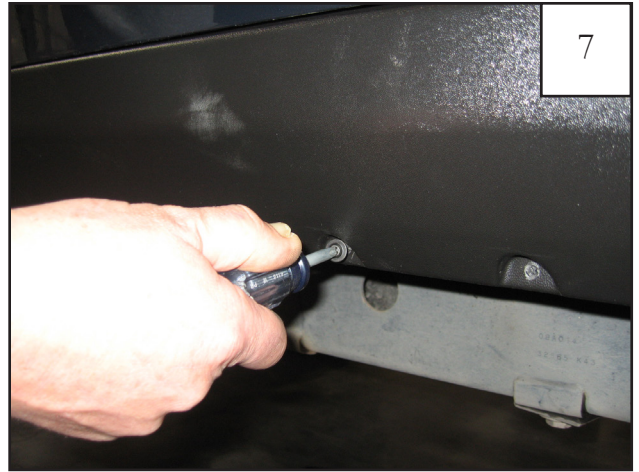

7
Using a #2 Phillips screwdriver, start a screw through each hole in side panel and through clips installed in step 4. **DO NOT TIGHTEN SCREWS.**

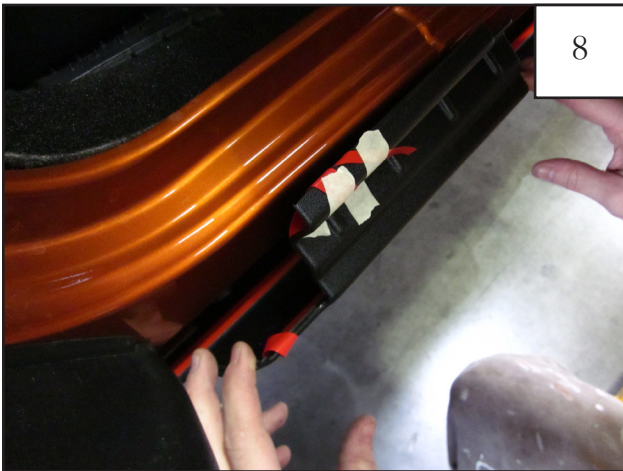

8
The top of the part should hang out away from the vehicle.

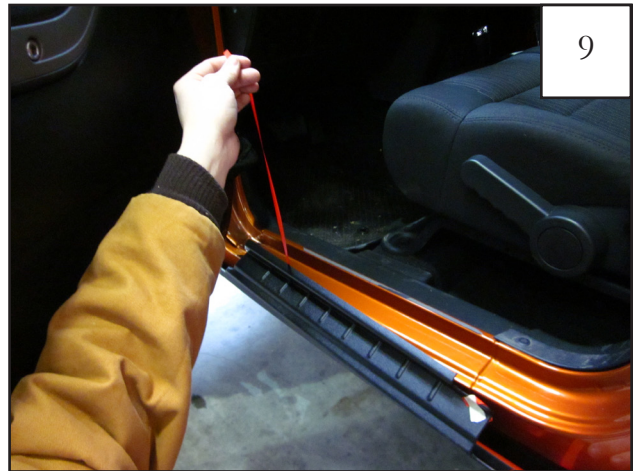

9
Remove all tape liners from the part in the order listed in step 1. As each liner is removed, press firmly on part at tape location to ensure adhesion.

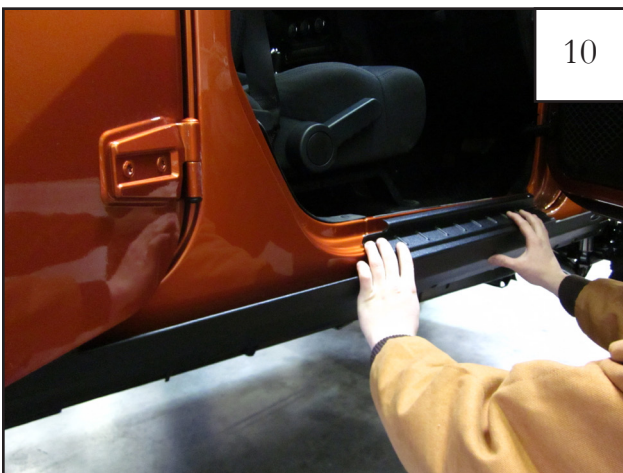

10
Press the part firmly into place following tape liner removal.



11
Tighten all screws.



Complete Installation.