



n-fab.com

a TRUCK HERO company

nfabinc f t

I-SHEET #: INST-00033

PART NUMBER: PRJ1846

PRODUCT: ALUMINUM HOOP STEP

APPLICATION: 18- C JEEP JL 2 DOOR

PREDATOR PRO



| HARDWARE DESCRIPTION | QTY. |
|--------------------------------|------|
| # HWKT-00029X | 1 |
| M8 FENDER WASHER | 4 |
| M8-1.25MM X 35MM HEX CAP SCREW | 4 |
| 1/4"-20 x 3/4" HEX CAP SCREW | 8 |
| 1/4" USS FLAT WASHER | 8 |
| 1/4"-20 CLIP-ON NUT | 4 |

Step 1: Identify Driver and Passenger side Nerf-step.

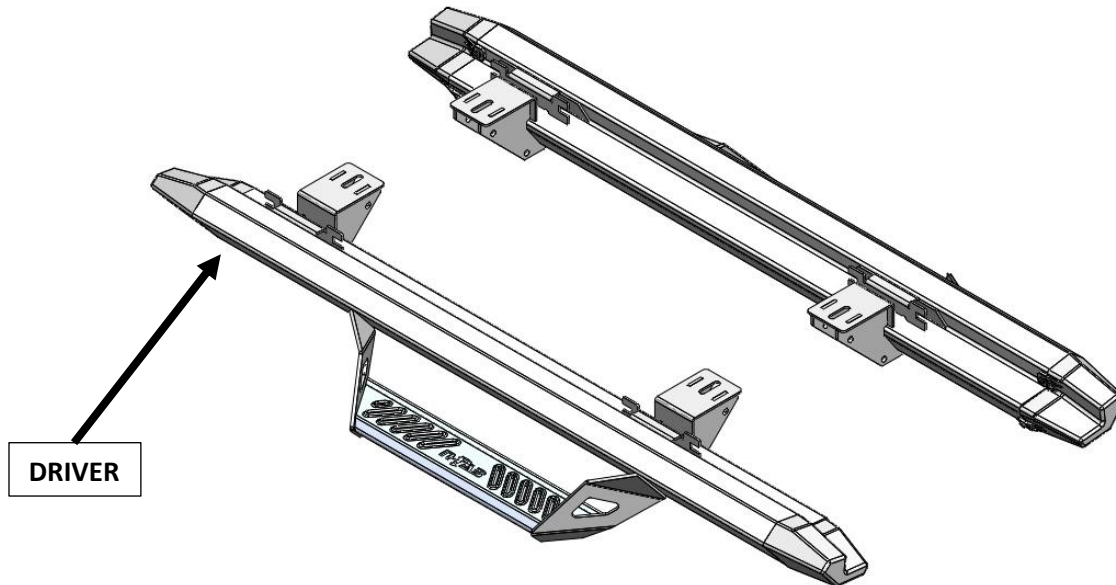

Step. 2 Starting with the passenger side step rail, install the supplied (x4) 5/16" snap nuts into the two notches in each mounting bracket.

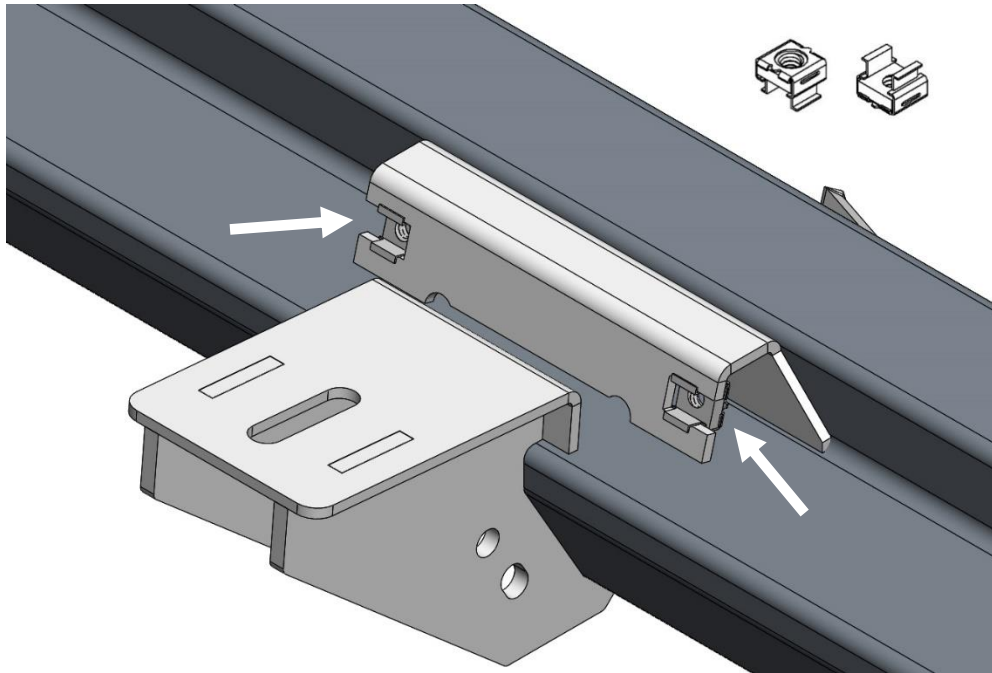

Step. 3 Carefully raise step rail up to the pinch weld of the body and align brackets up with the factory mounting locations.

Step. 4 Beginning with the front bracket start one of the supplied M8X30mm Hex bolts and leave loose to help steady the step to install the remaining hardware.



Step 5. Next, install the remaining M8x30mm hex bolts in the upper mount on the rear bracket and leave loose at this time.

Step. 6 Next, start all (x4) $\frac{1}{4}$ "x $\frac{3}{4}$ " hex bolts and (x4) M8 flat washers in the upper bracket mounts through the pinch weld and leave loose.

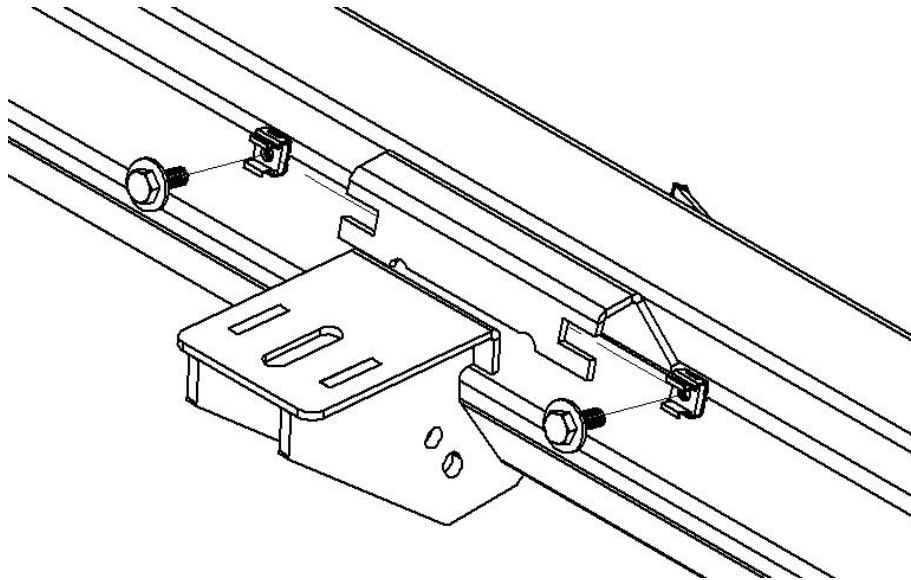

Step. 7 After final positioning, tighten all (x4) $\frac{1}{4}$ "x $\frac{3}{4}$ " hex bolts no more than 6 ft/lbs. torque.

Step. 8 Next, tighten all (x2) lower mounting positions to 17-20 Ft/lbs. torque.

Step. 9 Repeat steps 2-8 for passenger side.